

### A. Package content

- Controller X 1, CD x 1, Warranty card X 1, Installation Guide X 1
- Accessory kit X 1(Screw X 4, Spacer X 4, 1N4004 X 1), Wiring sticker x 1

### B. Installation

- Physical Dimension: 138 x 114 x 27 (mm)
- Recommended: Cable with shielded, Linear DC power supply, Network cable.
- Specifications
  - Voltage range: 9~24 VDC
  - Controller Power Consumption: 180mA (Exclude external device power consumption)
  - Power recommend: 1A (Includes relay expansion module and an external reader device power consumption)
  - Please do not exceed 300mA for external wiegand reader
  - Max distance for wiegand is 80M
- Notice
  - Do not connect other cables to the power unit except power contacts.
  - Do not apply any unverified power supply to the unit. (Might cause hardware damage and system unstable)
- Optional
  - Chassis Size 225 x 285 x 85 (mm)
  - Relay Expansion Module

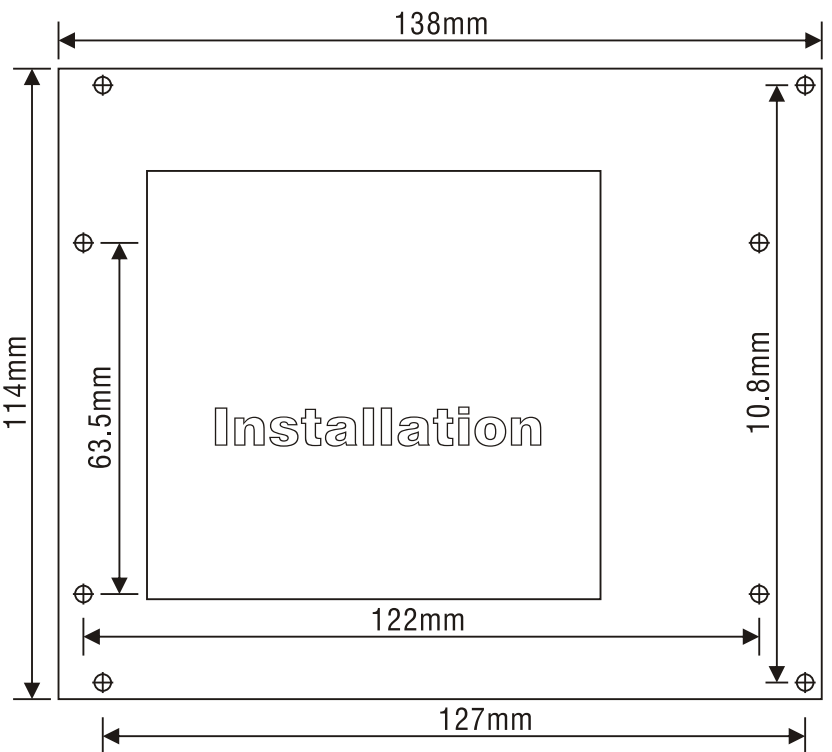

### C. Structure

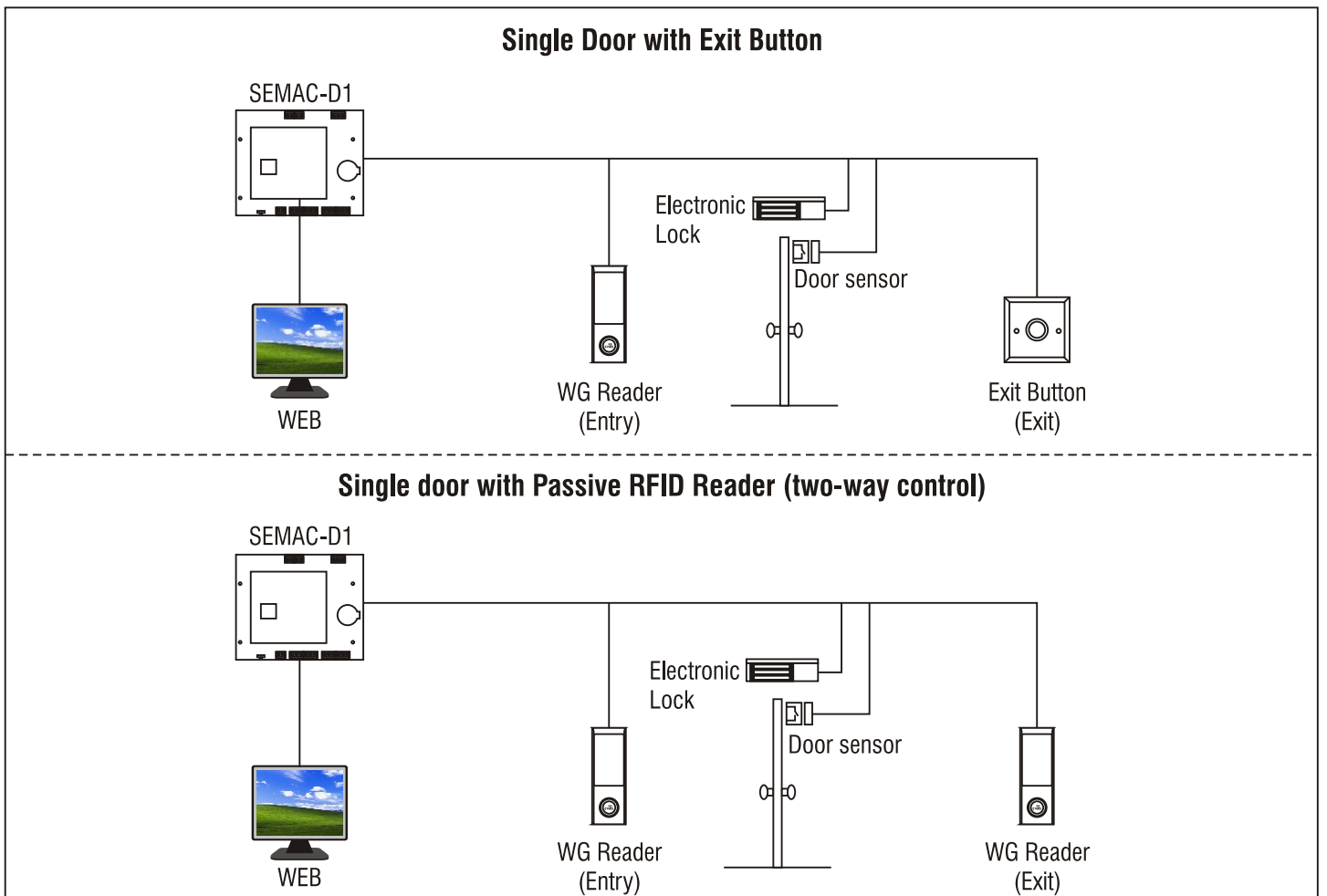

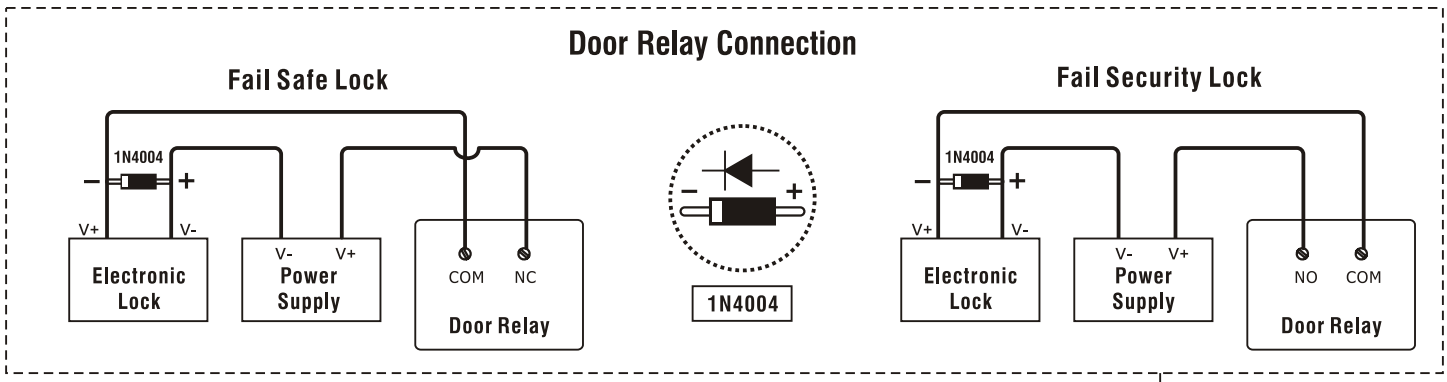

### D. Wiring Diagram

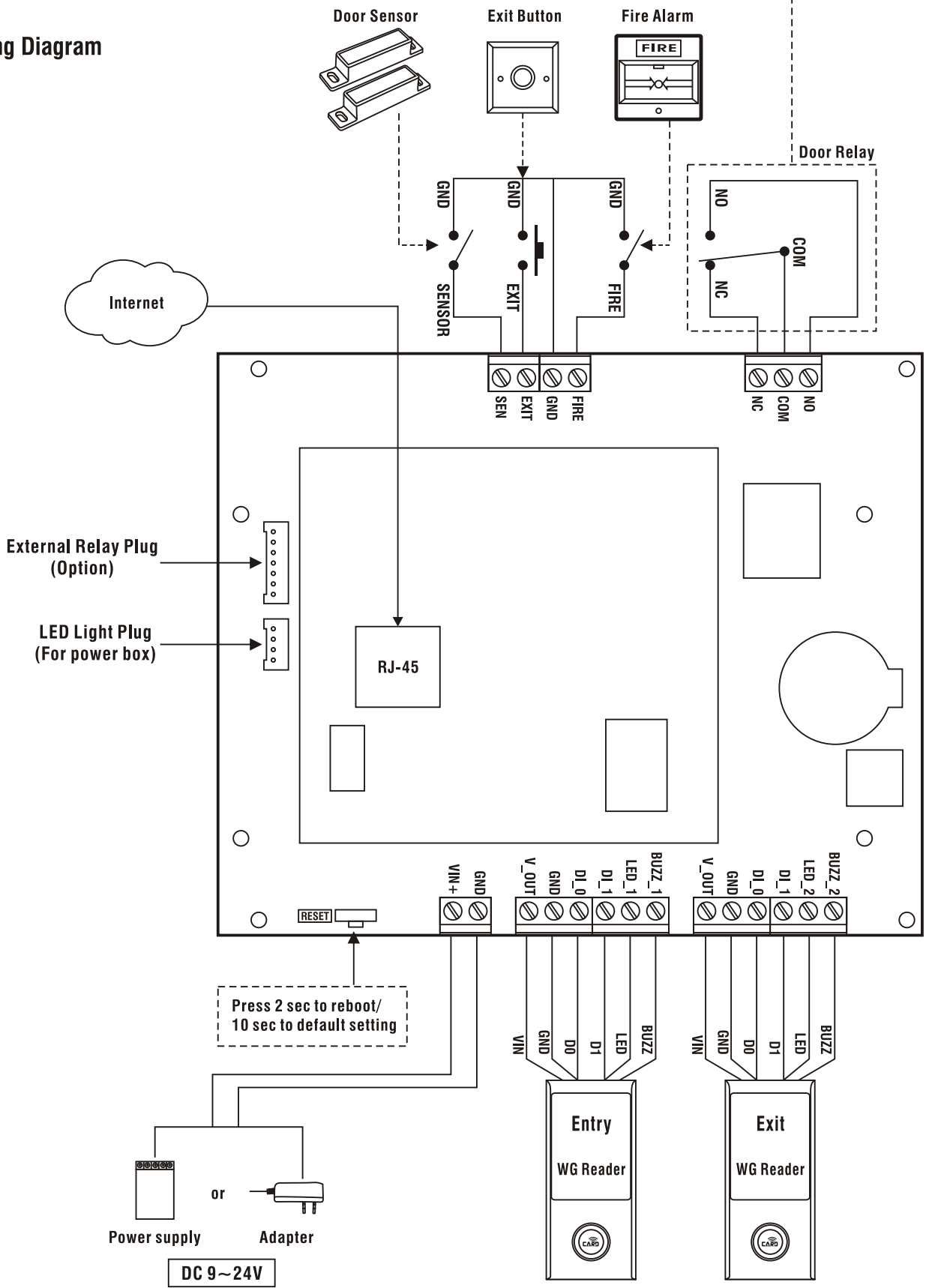

# **SEMADC-D1**

## **WEB Configuration Manual**

For SEMAC-D Series Only: 1.00.00,Dec 23 2013(HW1.1)  
SEMAC Web Ver1.0 / Build Date 12/23/2013

# 【Contents】

<b>WEB Configuration</b> .....	1
Logon WEB.....	1
Premise.....	1
WEB IE Browser.....	1
<b>Main Window (Terminal Status)</b> .....	2
Illustration of Terminal Status Screen.....	3
<b>User Administration</b> .....	4
Log/Report.....	4
Illustration of Access Log.....	5
Auto Refresh Log.....	6
View User List.....	6
Illustration of User List.....	7
Modify User Record.....	8
Modify User List in “View User List”.....	9
Add User.....	10
Illustration of Add New User.....	11
<b>Terminal</b> .....	12
Terminal Status.....	12
Illustration of Terminal Status.....	13
Terminal Setup.....	14
Illustration of Terminal Configuration.....	15
Password Setup.....	17
Illustration of WEB Logon Setting/Entrance Password.....	18
System Log.....	20
Illustration of System Log.....	20
Clock Setup.....	21
Illustration of System Clock Setup.....	21
<b>Access Control</b> .....	22
Time Set.....	22
Illustration of Time Set.....	22
Time Zone Setup.....	23
Illustration of Time Zone List.....	23
Illustration of Time Zone Information.....	24
Group List.....	25

Illustration of Group List.....	25
Illustration of Group Information.....	26
Holiday Setup.....	27
Illustration of Holiday Setup.....	27
Door Setup.....	28
Illustration of Door Setting.....	29
Illustrations of Door 1 Setting in Door Setup.....	32
Remote Control.....	35
Illustrations of Door Status Monitoring/Security Bypass.....	36
Event Handle.....	37
Illustration of Event Handle.....	38
Multi Badge Group.....	42
Illustration of Multi Badge Group.....	42
<b>TOOLS.....</b>	<b>43</b>
IP Camera.....	43
Illustration of IP Camera.....	43
Backup.....	43
Restore.....	44
Reboot.....	44
Illustration of Reboot.....	44
Upgrade Firmware.....	45
Illustration of Upgrade Firmware.....	45
Reset.....	46
Illustration of Reset.....	46

# — WEB Configuration —

## SEMAC-D1 WEB Configuration

### ◆ Logon WEB

SEMAC-D1 is with built-in HTTP server for using WEB IE Browser to connect SEMAC-D1 and execute the settings of SEMAC-D1.

### ◆ Premise

Please make sure the following points before your SEMAC-D1 settings:

- Your PC computer may build up a physical connection with SEMAC-D1, meanwhile, both of your computer and the SEMAC-D1 are within the same Network Segment.
- SEMAC-D1 has been installed and with power.
- Should the default IP address of SEMAC-D1 ( 192.168.0.66 ) has been occupied by other devices, you have to shut down all the other devices until the setting completed. Then a new IP address will be distributed to the SEMAC-D1.

### ◆ WEB IE Browser

- 1 · Start the WEB IE Browser first.
- 2 · Enter the <http://> and the IP address of SEMAC-D1 in the address bar. For example, enter the default IP address of SEMAC-D1: <http://192.168.0.66>.

#### **Communication failure:**

When no feedback from the SEMAC-D1, please check as below:

- Is the SEMAC-D1 installed properly, the local area network (LAN) connected well or the power connected fine? Try to use the “ping” command to test the communication status of SEMAC-D1 IP address by the following steps:
  - Open a MS-DOS window, or a command window;
  - Input your command: ping 192.168.0.66,  
For example : C:\user\tank>ping 192.168.0.66If no any response, it indicated abnormal connection or the PC computer IP address in conflict or not match with SEMAC-D1 IP address (referring to next paragraph) .
- If a PC computer with a Static IP/Fixed IP, the IP range should be defined between 192.168.0.1~ 192.168.0.65 or 192.168.0.67~192.168.0.254. So the PC computer IP may be compatible with the default IP address of SEMAC-D1, 192.168.0.66. Moreover, the Subnet Mask should be as 255.255.255.0 .
- To make sure both your PC computer and the SEMAC-D1 in the same Network Segment.

## ➤ Main Window (Terminal Status)

When installation completed and well connected with SEMAC-D1, the “Terminal Status” window will be pop-up. It will show after the following connection frequently as following illustration:

### TERMINAL STATUS

<b>Product Name :</b>	SEMAC-D1(20000)
<b>Serial No. :</b>	038fdc(113222)
<b>Firmware Version :</b>	1.00.00,Dec 23 2013(HW1.1)
<b>System Time :</b>	02/11/2014 10:55:50
<b>Terminal ID(MAC Address) :</b>	1(00:0e:e3:03:8f:dc)
<b>IP Address :</b>	192.168.2.67
<b>Subnet mask :</b>	255.255.255.0
<b>Default Gateway :</b>	192.168.2.1
<b>Primary DNS :</b>	168.95.1.1
<b>Listen Port/Software IP(status) :</b>	2000/0.0.0.0(Offline)
<b>Web Management Port :</b>	67
<b>Registered User :</b>	0
<b>Available User Capacity :</b>	20000
<b>Access/System Log Count :</b>	0/6
<b>Reader Type :</b>	WG34
<b>Anti-Pass-Back(Tolerance Timer) :</b>	Disabled(0)
<b>Anti-Duress :</b>	Disabled
<b>Next SEMAC(status) :</b>	0.0.0.0(Offline)

## ◆ Illustration of Terminal Status Screen

Browse the Function Bar left side :

► User Administration	
<b>Log/Report</b>	Switch to the “Access Log” screen to check, search, export log reports
<b>Auto Refresh Log</b>	Press the button to refresh system to get new logs
<b>View User List</b>	Switch to the “User List” screen to Search/Modify/Delete/Deactivate/Activate user data
<b>Add User</b>	Switch to the “User Record” screen and input user data on the”Add New User ”screen
► Terminal	
<b>Terminal Status</b>	Switch to the “Terminal Status” screen ( Main Window)
<b>Terminal Setup</b>	Switch to the “Terminal Configuration” screen to input data
<b>Password Setup</b>	Switch to the “WEB Logon Setting” and “Entrance Password” screen.
<b>System Log</b>	Switch to the “System Log” screen.
<b>Clock Setup</b>	Switch to the “System Clock Setup” screen.
► Access Control	
<b>Time Set</b>	Switch to the “Time Set” screen.
<b>Time Zone Setup</b>	Switch to the “Time Zone List” screen.
<b>Group List</b>	Switch to the “Group List” screen.
<b>Holiday Setup</b>	Switch to the “Holiday Setup” screen.
<b>Door Setup</b>	Switch to the “Door Setting” screen.
<b>Remote Control</b>	Switch to the “Door Status Monitoring” and “Security Bypass” screen.
<b>Event Handle</b>	Switch to the “Event Handle” screen.
<b>Multi Badge Group</b>	Switch to the “Multi Badge Group” screen.
► Tools	
<b>IP Camera</b>	Switch to the “IP Camera Configuration“ screen.
<b>Backup</b>	Switch to Backup screen
<b>Restore</b>	Switch to Restore screen
<b>Reboot</b>	Switch to the “Reboot System“ screen.
<b>Upgrade Firmware</b>	Switch to the “Firmware Upgrade“ screen.
<b>Reset</b>	Switch to the “Reset“ screen.
► Button	
<b>Refresh</b>	Refresh the WEB Status.

## ➤ User Administration

### ◆ Log/Report

Select "Access Control" on the Main Window, you'll see the "Access Log/Query and Export" screen as the following picture:

#### Access Log/Query and Export

No.	User ID	User Name	Date	Time	IN/OUT	Door	Note.
-----	---------	-----------	------	------	--------	------	-------

No Log Data

#### Query and Export

<b>Type</b> <input checked="" type="radio"/> user <input type="radio"/> event	<b>Selection</b> <input checked="" type="radio"/> Single <input type="radio"/> All	<b>Start Date</b> <input type="text" value="2014/02/06"/>	<b>End Date</b> <input type="text" value="2014/02/06"/>
<b>User ID</b> <input type="text"/>	<b>Card No.(DEC)</b> <input type="text"/>		
<b>Export Type</b> <input checked="" type="radio"/> Txt <input type="radio"/> Xls	<input type="button" value="Search"/>	<input type="button" value="Export"/>	

SEMAAC

## ◆ Illustration of Access Log

▶ Query (BY)	
<b>Type</b>	By User or Event
<b>Selection</b>	Single or All
<b>Start / End Date</b>	From – To Date period input
<b>User ID</b>	Input User ID or Card No. (in Decimal format)
<b>Export Type</b>	Text (txt) or Excel (xls) format
▶ Access Records Illustration by Columns	
<b>No.</b>	Serial Number
<b>User ID</b>	A system User ID assigned for the user to access door(s). Click the “User ID” to enter the page of “User Record” and “Modify User Record”. ※ The figure in the parentheses ( ) after the “User ID” is indicated the user’s Bypass TZ level as 1~10
<b>User Name</b>	User name has registered to the current system
<b>Date</b>	A date period allowed user(s) to access door(s)
<b>Time</b>	A Time allowed for the User to get IN/OUT.
<b>IN/OUT</b>	<b>1 Door/ 2 Way:</b> IN: Open the door by punching card at the outside of door reader to get IN records OUT: Open the door by pressing push button inside of a door to get OUT records ※ The figure in the parentheses ( ) after the “IN/OUT” record indicated APB (Anti Pass Back) level.
<b>Door</b>	Indicating the Door Number controlled by SEMAC-D1.
<b>Note</b>	Show up the relative IN/OUT records automatically as Anti-Duress, Fire Alarm.....etc.
<b>the First Page</b>	Back to the 1st IN/OUT records page.
<b>the Former 10 pages</b>	Forwarding 10 pages from the current IN/OUT records page.
<b>1 2 3...N page</b>	Change to any IN/OUT records page assigned.
<b>the Latter 10 pages</b>	Backwards 10 pages from the current IN/OUT records page.
<b>the Last Page</b>	Fly to the last IN/OUT records page directly.

## ◆ Auto Refresh Log

Auto Refresh Log Wed Feb 05 2014 17:52:31 GMT+0800 (台北標準時間)

No.	User ID	User Name	Date	Time	IN/OUT Door	Note.
-----	---------	-----------	------	------	-------------	-------

## ◆ View User List

Select "View User List" on the Main Window, you'll see the "User List" screen as the following picture:

### User List

Search User :   By User ID  By Card No.(DEC)  By User Name

\*Reg Type: F(Fingerprint) , P>Password) , C(Card)

No.	User ID	User Name	User Type	Active	F	P	C	Bypass Level
<input type="checkbox"/> 1.	<a href="#">115</a>	Katherine	Normal	<input checked="" type="radio"/>	<input type="radio"/>	<input type="radio"/>	<input checked="" type="radio"/>	1

Total 1 User(s)

<< End of List... >>

Activate, Deactivate or Delete SELECTED Employee

## ◆ Illustration of User List

▶ Search User By	
<b>By “User ID”</b>	Select “User ID”and Enter your “User ID”in the textbox to search.
<b>By “Card No.”(DEC)</b>	Select “Card No.”and Enter your“Card No.”in the textbox to search.
<b>By “User Name”</b>	Select “User Name.”and Enter your“User Name”in the textbox to search.
<b>Click “GO” Button</b>	Start to search.
<b>Steps :</b>	
1、Enter your “User ID”, “Card No.” or “User Name” in the “blank textbox”	
2、Click button “GO” to search.	
▶ User List	
<b>No.</b>	Serial Number. Tick the box before the “Serial Number” and Click the button of “Activate” , “Deactivate” or “Delete” to manage the authorization of “Activate” , “Deactivate” or “Delete” for selected users, multi-selection is allowed.
<b>User ID</b>	User’s ID. Click the “User ID” to enter the “Modify User Record” page.
<b>User Name</b>	Display User Name in the system.
<b>User Type</b>	Types of the User. Whenever the “User Type” is set up in the screen of “Modify User Record”, this page will display Normal User, Super User, Visitor, Guard Touring and Defense Card according to the setup.
<b>Active</b>	Display the user’s authorization status. Green Light indicated the user’s door access authority is being activated, otherwise it is not activated.
<b>P</b>	When the user’s Personal Password registered, this column will be with Green Light.
<b>C</b>	When the user’s card registered, this column will be with Green Light.
<b>Bypass Level</b>	Display the user’s Time Zone level of Bypass from L1~L10.
<b>the First Page</b>	Back to the 1st page of “User List”.
<b>the Former10 pages</b>	Forwarding 10 pages from the current “User List” page.
<b>1 2 3...N page</b>	Change to any “User List” page assigned.
<b>the Latter 10 pages</b>	Backwards 10 pages from the current “User List” page.
<b>the Last Page</b>	Fly to the last “User List” page directly.
▶ Button	
<b>Activate</b>	Activate the User’s authorization.
<b>Deactivate</b>	Deactivate the User’s authorization.
<b>Delete</b>	Delete the User’s information registered.

## ◆ Modify User Record

Select "Modify User Record" on the Main Window, you'll see the " User Record" screen as following picture:

**User Record**  
**Modify User Record**

---

User ID :  (1 ~ 20000 )  
Card No. :  (DEC)  
Name :  (Max 31 chars.)  
Expire Date Check :  Disable  Enable  
From  (Y)  (M)  (D)  (H)  (M)  
To  (Y)  (M)  (D)  (H)  (M)  
Status :  Activate  Deactivate  
User Type :  ▾  
Group : 1.  ▾ 2.  ▾ 3.  ▾ 4.  ▾  
Bypass TZ Level :  ▾  
Personal Password :  (4 ~ 8 digits.)  
Personal Confirm :

---

SEMAAC

## ◆ Modify User List in “View User List”

► User Record	
<b>User ID</b>	Self-define User ID from number 1~20,000 is allowed only.
<b>Card No.</b>	Manual input card no. in decimal format (when any card decoder installed, card no. can be read automatically)
<b>Name</b>	Input User’s Name ( max. 31 characters)
<b>Expire Date Check</b>	Enable or Disable user’s authority expire date check
<b>Effective From ~To</b>	When “Expire Date Check” enabled. It requires to enter a period of date time.
<b>Status</b>	“Activate” or “Deactivate” user access authority for system
<b>User Type</b>	<p>Card Types of the User. The “Drop Down Menu” will list out cards for <b>Normal User , Super User, Visitor, Guard Touring, Defense Card ,</b> Manager Card-Add and Manager-Card-Delete as your choice. The Respective definitions are as below :</p> <p><b>Normal User:</b> System default type for common users.</p> <p><b>Super User Card:</b> Not constrained by APB (Anti Pass Back) rule.</p> <p>Visitor Card: Program visitor cards with certain date access permission (expired date check)</p> <p><b>Guard Touring Card:</b> Door won’t open when Guard Touring card punched but log will be kept on system.</p> <p><b>Defense Card:</b> When the card sweeps the door, all the doors will activate Access Control at once. Any type of cards cannot access the door until the <b>Defense Card</b> punch again to restore normal functions.</p>
<b>Group</b>	Each user can be assigned to 4 different groups. All of the group names existed will be automatically listed out by the “Drop Down Menu” for your choice. “Free Time Group” is a “Default Group”.
<b>Bypass TZ Level</b>	The “Bypass Time Zone Level” of each user is from L1~L10. When user’s Bypass TZ level >Door Bypass TZ Level, User may access door by card only. When user’s Bypass TZ level < Door’s Bypass TZ level, user should access the door by door’s setup bypass level.
<b>Personal Password</b>	4~8 digits allow only
<b>Personal Confirm</b>	Reconfirm Personal Password.
► Button	
<b>Previous</b>	Modify previous user record.
<b>Save</b>	Save the modified user record.
<b>Delete</b>	Delete existing user record.
<b>Next</b>	Modify next user record.

## ◆ Add User

Select "Add User" on the Main Window, you'll see the User Record " screen for Add New User as the following picture:

---

### Add New User

---

REG :  Single  Continuous    Amount :

User ID :  (1 ~ 20000 )

Card No. :  (DEC)

Name :  (Max 31 chars.)

Expire Date Check :  Disable  Enable

From  2014  (Y)  02  (M)  06  (D)  15  (H)  0  (M)

To  2014  (Y)  02  (M)  06  (D)  15  (H)  0  (M)

Status :  Activate  Deactivate

User Type :  Normal User

Group : 1.  Free Time Group  2.  Disallowed Group  3.  Disallowed Group  4.  Disallowed Group

Bypass TZ Level :  L1

Personal Password :  (4 ~ 8 digits.)

Personal Confirm :

SEMLA

## ◆ Illustration of Add New User

► User Record	
<b>REG</b>	Single: Only one user can be registered each time. Continuous: It allows you to register 1~20000 users continually. You may input required q'ty in the textbox of Amount. However, only the serial number is accepted and supported.
<b>User ID</b>	Self-define User ID from number 1~20,000 is allowed only.
<b>Card No.</b>	Manual input card no. in decimal format (when any card decoder installed, card no. can be read automatically)
<b>Name</b>	Input User's Name ( max. 31 characters)
<b>Expire Date Check</b>	Enable or Disable user's authority expire date check
<b>Effective From ~To</b>	When "Expire Date Check" enabled. It requires to enter a period of date time.
<b>Status</b>	"Activate" or "Deactivate" user access authority for system
<b>User Type</b>	<p>Card Types of the User. The "Drop Down Menu" will list out cards for <b>Normal User , Super User, Visitor, Guard Touring, Defense Card ,</b> Manager Card-Add and Manager-Card-Delete as your choice. The Respective definitions are as below :</p> <p><b>Normal User:</b> System default type for common users.</p> <p><b>Super User Card:</b> Not constrained by APB (Anti Pass Back) rule.</p> <p><b>Visitor Card:</b> Program visitor cards with certain date access permission (expired date check)</p> <p><b>Guard Touring Card:</b> Door won't open when Guard Touring card punched but log will be kept on system.</p> <p><b>Defense Card:</b> When the card sweeps the door, all the doors will activate Access Control at once. Any type of cards cannot access the door until the <b>Defense Card</b> punch again to restore normal functions.</p>
<b>Group</b>	Each user can be assigned to 4 different groups. All of the group names existed will be automatically listed out by the "Drop Down Menu" for your choice. "Free Time Group" is a "Default Group".
<b>Bypass TZ Level</b>	The "Bypass Time Zone Level" of each user is from L1~L10. When user's Bypass TZ level >Door Bypass TZ Level, User may access door by card only. When user's Bypass TZ level < Door's Bypass TZ level, user should access the door by door's setup bypass level.
<b>Personal Password</b>	4~8 digits allow only
<b>Personal Confirm</b>	Reconfirm Personal Password.
► Button	
<b>Save</b>	Save user records.

## ➤ Terminal

### ◆ Terminal Status

Select and Click”Terminal Status” on the left side of the Main Window, you’ll see the “Terminal Status” screen. This screen is the Main Window for Logon. It displays the current Terminal Status and relative information of WEB setup, referring to the following picture:

## TERMINAL STATUS

<b>Product Name :</b>	SEMAC-D1(20000)
<b>Serial No. :</b>	036fdc(113222)
<b>Firmware Version :</b>	1.00.00,Dec 23 2013(HW1.1)
<b>System Time :</b>	02/11/2014 10:55:50
<b>Terminal ID(MAC Address) :</b>	1(00:0e:e3:03:6f:dc)
<b>IP Address :</b>	192.168.2.67
<b>Subnet mask :</b>	255.255.255.0
<b>Default Gateway :</b>	192.168.2.1
<b>Primary DNS :</b>	168.95.1.1
<b>Listen Port/Software IP(status) :</b>	2000/0.0.0.0(Offline)
<b>Web Management Port :</b>	67
<b>Registered User :</b>	0
<b>Available User Capacity :</b>	20000
<b>Access/System Log Count :</b>	0/6
<b>Reader Type :</b>	WG34
<b>Anti-Pass-Back(Tolerance Timer) :</b>	Disabled(0)
<b>Anti-Duress :</b>	Disabled
<b>Next SEMAC(status) :</b>	0.0.0.0(Offline)

## ◆ Illustration of Terminal Status

► Terminal Status	
<b>Product Name</b>	Model Number of SEMAC-D1
<b>Serial No.</b>	Serial Number of SEMAC-D1
<b>Firmware Version</b>	Firmware and Hardware Version of SEMAC-D1
<b>System Time</b>	System Time of SEMAC-D1
<b>Terminal ID (MAC Address)</b>	Terminal ID and MAC address of SEMAC-D1
<b>IP Address</b>	Current IP address of SEMAC-D1
<b>Subnet mask</b>	Subnet mask of SEMAC-D1
<b>Default Gateway</b>	Default Gateway address of SEMAC-D1
<b>Primary DNS</b>	Primary DNS address of SEMAC-D1
<b>Listen Port/Software IP(status)</b>	Listen Port and Networking Software IP address ( status : Online or Offline)
<b>WEB Management Port</b>	WEB communication number of SEMAC-D1
<b>Registered User</b>	Registered user number of SEMAC-D1
<b>Available User Capacity</b>	Available Capacity of SEMAC-D1 to register users; Available user number(s) to be registered= Sum (20000) – Registered user(s)
<b>Access/ System Log Count</b>	The Sum from access and system logs of SEMAC-D1
<b>Reader Type</b>	Indicated connected reader format (default is WG34)
<b>Anti-Pass-Back (Tolerance Time)</b>	Current APB status (Enable or Disable) on SEMAC-D1, indicating with (APB Tolerance Time)
<b>Anti-Duress</b>	Current Anti-Duress status (Enable or Disable) on SEMAC-D1.
<b>Next SEMAC(status)</b>	IP Address of Next SEMAC-D1 which interaction with first APB (anti pass-back) function and Fire Alarm door emergency open. Also indicating with connectivity status ( Online or Offline)

## ◆ Terminal Setup

Select and Click "Terminal Setup" on the left side of the Main Window, you'll see the "Terminal Configuration", referring to the following picture:

### Terminal Configuration

**Terminal Setting :** Terminal ID :

\*IP Address :  .  .  .

\*Subnet Mask :  .  .  .

\*Gateway :  .  .  .

\*DNS Server :  .  .  .

**Software :** \*TCP Port(Software Used) :  \*Software IP :

**Web Language :**  ▼

**Anti Pass Back :**  Enable  Anti Follow  Disable

Tolerance Timer  (Minute, Maximum 65535, 0 means No Tolerance)

**Anti Duressed :**  Enable  Disable

Password  (Max 3 digits,default is 9)

**WEB Management Port :** Http Port:

**Next SEMAC(for APB):** IP Address :  .  .  .

**Fast Reg Card Mode :**  Enable  Disable

Terminal may need to restart after configuration saved.

SEMANTIC

## ◆ Illustration of Terminal Configuration

▶ Terminal Configuration	
<b>Terminal Setting: Terminal ID</b>	Setting Terminal ID for current SEMAC-D1. Default ID=1, max. 65,535 (Terminal ID should not be duplicated in one system)
<b>IP Address</b>	Setting IP Address of SEMAC-D1.
<b>Subnet Mask</b>	Setting Subnet Mask of SEMAC-D1
<b>Gateway</b>	Setting Default Gateway of SEMAC-D1
<b>DNS Server IP Address</b>	Setting the DNS Server IP Address of SEMAC-D1. Default DNS Server IP Address is 168.95.1.1.
▶ Software	
<b>TCP Port (Software Used)</b>	Setting a TCP Port for Software to communicate with SEMAC-D1. Default TCP Port No. is 2000
<b>Software IP</b>	For setting the Software IP to communicate with SEMAC-D1. Default Software IP is 0.0.0.0.
▶ Web Language	
<b>English</b>	When you choose the "English" language from the "Drop Down Menu", the WEB page of SEMAC-D1 will be switched to "English" interface .
<b>Chs</b>	When you choose the "Chs" language from the "Drop Down Menu", the WEB page of SEMAC-D1 will be switched to "Simplified Chinese" interface .
<b>Others</b>	When you choose "Others" from the "Drop Down Menu", the WEB page of SEMAC-D1 will be switched to "Traditional Chinese" interface or other languages.
▶ Anti Pass Back	
<b>Enable</b>	Tick this circle to enable the "APB"(Anti Pass Pack) function.
<b>Anti Follow</b>	Automatically set all door(s) with APB level: Entry (IN): 1, Exit (OUT):2. User should access door only from Entry side then exit from Exit side.
<b>Disable</b>	Tick this circle to disable the "APB"(Anti Pass Pack) function.
<b>Tolerance Time</b>	Set a time that system will be restored to original status after "APB" triggered. The unit of time can be 0~65535(minute). For value set to "0" which indicated APB function will not be restored to normal after certain time until manually disable "APB" function. (Default value=0)
▶ Anti Duress	
<b>Enable</b>	Tick this circle to enable the "Anti Duress" function.
<b>Disable</b>	Tick this circle to disable the "Anti Duress"function.
<b>Password</b>	Set a set of password for "Anti Duress" function. Default value = 9, max. 3 digits.

<b>► WEB Management Port</b>	
<b>Http Port</b>	Set your WEB communication port for SEMAC-D1, default value=80.
<b>► Next SEMAC( for APB)</b>	
<b>IP Address</b>	Set IP address for Next SEMAC-D1. All the APB level setting from first SEMAC-D1 will be copied to next SEMAC-D1.
<b>► Button</b>	
<b>Save</b>	Save the Terminal configuration settings.

SEMAC-D1

## ◆ Password Setup

Select "Password Setup" on the left side of the Main Window, you'll see the "WEB Logon Setting/Entrance Password" screen, referring to the following picture:

### WEB Logon Setting

---

Administrator WEB Logon User Name :  (47 Char. Max)

Administrator WEB Logon Password :  (35 Char. Max)

Operator WEB Logon User Name :  (47 Char. Max)

Operator WEB Logon Password :  (35 Char. Max)

USER WEB Logon User Name :  (47 Char. Max)

USER WEB Logon Password :  (35 Char. Max)

SAVE

### Entrance Password

---

Administrator Password :  (4 ~ 8 digits.)

Common Password :  (4 ~ 8 digits.)

SAVE

SEMI

## ◆ Illustration of WEB Logon Setting/Entrance Password

▶ WEB Logon Setting	
<b>Administrator WEB Logon User Name</b>	Input the required Administrator's logon user name for WEB management, max. 47 characters, default value: "admin".
<b>Administrator WEB Logon Password</b>	Input the required Administrator's logon password for WEB management, max. 35 digits, default value: "admin".
<b>Operator WEB Logon User Name</b>	Input the required Operator's logon user name for WEB management, max. 47 characters, default value: "user".
<b>Operator WEB Logon Password</b>	Input the required Operator's logon password for WEB management, max. 35 digits, default value: "user".
<b>User WEB Logon User Name</b>	Input the required User's logon user name for WEB management, max. 47 characters, default value: "user0".
<b>User WEB Logon Password</b>	Input the required User's logon user name for WEB management, max. 35 digits, default value: "user0".
The Administrator, Operator and User have their respective authorizations, referring to the following "Authorization Table".	
▶ Button	
<b>Save</b>	Save all the WEB Logon Settings.
▶ Entrance Password	
<b>Common Password</b>	Set your "Common Password" here. Meanwhile, you have to select "001 Any Time "for "Common Password Time Zone " simultaneously to support this setting ( for example: Door Setup→Door Setting→Click "Door1"→Door 1 Setting→ Select "Common Password Time Zone "→ Select "001 Any Time "from the "Drop Down Menu"). Default value: "1234".
▶ Button	
<b>Save</b>	Save the Password setting.

Authorizations Table (“●” = Access Permission)

WEB Function	Administrator User Name: admin Password : admin	Operator User Name: user Password : user	User User Name: user0 Password : user0
Upgrade Firmware	●		
Password Setup	●		
Terminal Setup	●		
Door Setup	●		
Event Handle	●		
Reboot	●		
Clock Setup	●		
Reset	●		
Upgrade Firmware	●		
Password Setup	●		
Terminal Setup	●		
User Data	●	●	
Time Set	●	●	
Time Zone Setup	●	●	
Group List	●	●	
Holiday Setup	●	●	
Multi Badge Group	●	●	
Remote Control	●	●	
Access Log	●	●	●
View User List	●	●	●
Terminal Status	●	●	●
System Log	●	●	●
IP Camera	●	●	●

## ◆ System Log

Select "System Log" on the left side of the Main Window, you'll see "System Log" screen as the following picture:

### System Log

No.	Date	Time	Description
1 .	02/10/2014	16:08:32	System Power ON
2 .	01/29/2014	16:39:17	System Warm Start
3 .	01/29/2014	16:39:16	System Terminal Setup from Web
4 .	01/29/2014	16:38:54	System Warm Start
5 .	01/29/2014	16:37:30	System Power ON
6 .	01/29/2014	16:06:01	ETH Dev Link Down

Total 6 Record(s) < End of List.. >

## ◆ Illustration of System Log

► System Log	
<b>No.</b>	Serial Number of the log
<b>Date</b>	Date of the log
<b>Time</b>	Time of the log
<b>Description</b>	Description of the system operation records
※ Max. logs capacity : 1536 entries, for checking by authorized person(s) only, no logs export provide.	

## ◆ Clock Setup

Select and Click "Clock Setup" on the left side of the Main Window, you'll see the "System Clock Setup" screen, referring to the following picture:

### SYSTEM CLOCK SETUP

Time Server :  Disable  Enable

*Recommend: time.windows.com or time.nist.gov*

Time Zone:

New Date :  (mm/dd/yyyy)

New Time :  (hh:mm:ss)

## ◆ Illustration of System Clock Setup

► Time Server	
<b>Disable</b>	Tick this circle to shut up the Time Server network connection.
<b>Enable</b>	Tick this circle to start the Time Server network connection.
<b>Time Zone</b>	The "Drop Down Menu" offers you all the Time Zones available up to your option, default time zone : (GMT)England.
<b>"Save" button</b>	Save the Time Server Settings and adjust the time.
When enable the "Time Server", please key in the IP address or <a href="http://">http://</a> of the "Time Server". Then select the required Time Zone and Save it to connect the "Time Server" for a time adjustment.	
<b>New Date</b>	The date of networked PC computer. You may adjust the date to your requirement as the format of " <b>mm/dd/yyyy</b> ".
<b>New Time</b>	The date of networked PC computer. You may adjust the time to your requirement as the format of " <b>hh:mm:ss</b> ".
<b>"Save" button</b>	Save the configuration of this page and upgrade the date/time for the networked PC computer.

## ➤ Access Control

### ◆ Time Set

Select and Click “Time Set” on the left side of the Main Window, you’ll see the “Time Set” screen, referring to the following picture:

#### Time Set

Time Set List :

000	00:00 ~ 00:00		001	00:00 ~ 23:59	
002	04:00~17:00	DELETE	003	18:00~23:00	DELETE
004	02:00~05:30	DELETE	005	15:00~19:00	DELETE
006	16:00~19:00	DELETE	007	07:00~16:00	DELETE
008	17:30~21:30	DELETE	009	03:45~09:30	DELETE
010	10:00~14:00	DELETE	011	09:00~17:00	DELETE
012	17:00~22:00	DELETE	013	00:00~13:00	DELETE
014	19:00~23:00	DELETE	015	07:30~15:00	DELETE
016	16:00~20:00	DELETE	017	12:58~19:56	DELETE
018	12:58~18:59	DELETE	019	02:00~08:00	DELETE
020	03:00~05:00	DELETE	021	07:00~13:00	DELETE

Time Set :  From  H :  M To  H :  M

### ◆ Illustration of Time Set

▶ Time Set List	
<b>Time Set List</b>	It will display all the configured time set(s). The System Default Time sets are: 00:00~00:00 and 00:00~23:59.
<b>Time Set</b>	Select your time set serial number. The “Drop Down Menu” offers you all the options for your choice, max. 255 time sets allowed. System built-in values are “000” and “001”.
<b>From ~ To</b>	Input a time set period, for example : 8:00am to 17:00pm as one period, then Time Set : <input type="text" value="002"/> From <input type="text" value="00"/> H : <input type="text" value="00"/> M To <input type="text" value="23"/> H : <input type="text" value="59"/> M <input type="button" value="SET"/> It is the same way to the others.
▶ Button	
<b>Delete</b>	Delete an existing “Time Set”.
<b>Set</b>	Add a new “Time Set”.

## ◆ Time Zone Setup

Select and Click”Time Zone Setup” on the left side of the Main Window, you’ll see the “Time Zone List” screen as below:

### Time Zone List

Time Zone List :

000	Deactivate		001	Any Time	
002	2	DELETE	003	3	DELETE
004	4	DELETE	005	5	DELETE

Time Zone ID :

## ◆ Illustration of Time Zone List

▶ Time Zone List	
<b>Time Zone List</b>	Display all the Time Zone(s) existing. Click the Time Zone name(indicated as the Time Zone Name example) to enter its Time Zone Information Screen.
<b>Time Zone ID</b>	Select your Time Zone Serial Number from the “Drop Down Menu”, system built-in numbers as “000” and “001”, max. 120 Time Zones allowed.
<b>Time Zone Name</b>	Click the name of Time Zone ( for example : 2, as below picture) to enter the ”Time Zone Information” screen for modification.
▶ Button	
<b>Delete</b>	Delete an existing Time Zone.
<b>Set</b>	Enter the Time Zone Information screen.

※ Example of “Time Zone Information” screen to show how to set the daily door access and card punching authorized Time Set from Monday to Sunday and Holidays:

**Time Zone Information -- 002**

Day : Monday ▾

Time 1: <span>000 -- 00:00 ~ 00:00</span> ▾	Time 2: <span>000 -- 00:00 ~ 00:00</span> ▾	Time 3: <span>000 -- 00:00 ~ 00:00</span> ▾	Time 4: <span>000 -- 00:00 ~ 0</span>
Time 5: <span>000 -- 00:00 ~ 00:00</span> ▾	Time 6: <span>000 -- 00:00 ~ 00:00</span> ▾	Time 7: <span>000 -- 00:00 ~ 00:00</span> ▾	Time 8: <span>000 -- 00:00 ~ 0</span>
Time 9: <span>000 -- 00:00 ~ 00:00</span> ▾	Time 10: <span>000 -- 00:00 ~ 00:00</span> ▾	Time 11: <span>000 -- 00:00 ~ 00:00</span> ▾	Time 12: <span>000 -- 00:00 ~ 0</span>
Time 13: <span>000 -- 00:00 ~ 00:00</span> ▾	Time 14: <span>000 -- 00:00 ~ 00:00</span> ▾	Time 15: <span>000 -- 00:00 ~ 00:00</span> ▾	Time 16: <span>000 -- 00:00 ~ 0</span>

Save Cancel

	Monday	Tuesday	Wednesday	Thursday	Friday	Saturday	Sunday	Hc
Time 1:	000 -- 00:00 ~ 00:00	000 -- 00:00 ~ 00:00	000 -- 00:00 ~ 00:00	000 -- 00:00 ~ 00:00	000 -- 00:00 ~ 00:00	000 -- 00:00 ~ 00:00	000 -- 00:00 ~ 00:00	00
Time 2:	000 -- 00:00 ~ 00:00	000 -- 00:00 ~ 00:00	000 -- 00:00 ~ 00:00	000 -- 00:00 ~ 00:00	000 -- 00:00 ~ 00:00	000 -- 00:00 ~ 00:00	000 -- 00:00 ~ 00:00	00
Time 3:	000 -- 00:00 ~ 00:00	000 -- 00:00 ~ 00:00	000 -- 00:00 ~ 00:00	000 -- 00:00 ~ 00:00	000 -- 00:00 ~ 00:00	000 -- 00:00 ~ 00:00	000 -- 00:00 ~ 00:00	00
Time 4:	000 -- 00:00 ~ 00:00	000 -- 00:00 ~ 00:00	000 -- 00:00 ~ 00:00	000 -- 00:00 ~ 00:00	000 -- 00:00 ~ 00:00	000 -- 00:00 ~ 00:00	000 -- 00:00 ~ 00:00	00
Time 5:	000 -- 00:00 ~ 00:00	000 -- 00:00 ~ 00:00	000 -- 00:00 ~ 00:00	000 -- 00:00 ~ 00:00	000 -- 00:00 ~ 00:00	000 -- 00:00 ~ 00:00	000 -- 00:00 ~ 00:00	00
Time 6:	000 -- 00:00 ~ 00:00	000 -- 00:00 ~ 00:00	000 -- 00:00 ~ 00:00	000 -- 00:00 ~ 00:00	000 -- 00:00 ~ 00:00	000 -- 00:00 ~ 00:00	000 -- 00:00 ~ 00:00	00

**◆ Illustration of Time Zone Information**

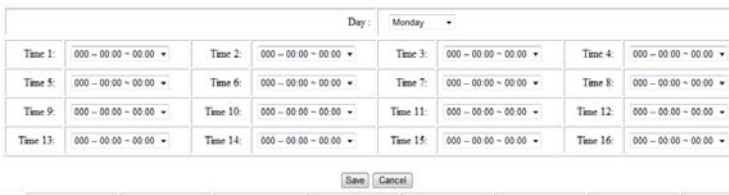
► Time Zone Information Settings													
<b>Weekday (Day)</b>	The “Drop Down Menu ”offers options from Monday to Sunday and Holiday. Steps:“SET”the Time Set on “Time Set” screen( Select a weekday (Choose your time set(s) of the time zones.												
<b>Time 1 ~ Time16</b>	<p>Each day from Monday ~Sunday and Holiday is allowed to set 16 time sets. However, you have to make some Time Sets on the “Time Set” screen in advance for the options here, otherwise only 2 default Time sets for option, referring to the following illustration:</p> <p>Step 1 : “Time Set” screen to “SET” some time sets</p> <p><b>Time Set</b></p> <p>Time Set List :</p> <table border="1"> <tr> <td>000</td> <td>00:00 ~ 00:00</td> <td></td> <td>001</td> <td>00:00 ~ 23:59</td> <td></td> </tr> <tr> <td>002</td> <td>08:30~18:00</td> <td><span>DELETE</span></td> <td>003</td> <td>12:00~20:00</td> <td><span>DELETE</span></td> </tr> </table> <p>Time Set : <span>004</span> ▾ From <span>00</span> H : <span>00</span> M To <span>23</span> H : <span>59</span> M <span>SET</span></p> <p>Step 2 : “Time Zone Information” screen for more options than original 2 default time sets</p> <p>Time Zone Information -- 002</p> 	000	00:00 ~ 00:00		001	00:00 ~ 23:59		002	08:30~18:00	<span>DELETE</span>	003	12:00~20:00	<span>DELETE</span>
000	00:00 ~ 00:00		001	00:00 ~ 23:59									
002	08:30~18:00	<span>DELETE</span>	003	12:00~20:00	<span>DELETE</span>								
► Button													
<b>Save</b>	Save the“Time Zone Information”.												
<b>Cancel</b>	Cancel or Modify the “Time Zone Information”.												
When the “ Time Zone Setup “ completed, please click the “Time Zone Name ”to enter its “Time Zone Information” screen and see the list with all of its time sets as below picture													

## ◆ Group List

Select "Group List" on the left side of the Main Window, you'll see the "Group List" screen as below:

### Group List

Group List :

000	Disallowed Group		001	Free Time Group	
002	<a href="#">2</a>	DELETE	003	<a href="#">3</a>	DELETE
004	<a href="#">4</a>	DELETE			

Group ID :

## ◆ Illustration of Group List

▶ Group List																			
<b>Group List</b>	<p>Display all the Groups configured. Click the Group's name to enter its "Group Information" as below : (for example: click Group Name "4" as picture 14)</p> <p><b>Group Information</b></p> <hr/> <table> <tr> <td><b>Allowed Door :</b></td> <td><b>Time Zone ID :</b></td> </tr> <tr> <td><input checked="" type="checkbox"/> 1.</td> <td><input type="text" value="002 2"/></td> </tr> <tr> <td><input checked="" type="checkbox"/> 2.</td> <td><input type="text" value="004 4"/></td> </tr> <tr> <td><input checked="" type="checkbox"/> 3.</td> <td><input type="text" value="001 Any Time"/></td> </tr> <tr> <td><input checked="" type="checkbox"/> 4.</td> <td><input type="text" value="003 3"/></td> </tr> <tr> <td><input type="checkbox"/> 5.</td> <td><input type="text" value="000 Deactivate"/></td> </tr> <tr> <td><input type="checkbox"/> 6.</td> <td><input type="text" value="000 Deactivate"/></td> </tr> <tr> <td><input checked="" type="checkbox"/> 7.</td> <td><input type="text" value="001 Any Time"/></td> </tr> <tr> <td><input type="checkbox"/> 8.</td> <td><input type="text" value="000 Deactivate"/></td> </tr> </table> <hr/> <p style="text-align: center;"><input type="button" value="SAVE"/> <input type="button" value="CANCEL"/></p>	<b>Allowed Door :</b>	<b>Time Zone ID :</b>	<input checked="" type="checkbox"/> 1.	<input type="text" value="002 2"/>	<input checked="" type="checkbox"/> 2.	<input type="text" value="004 4"/>	<input checked="" type="checkbox"/> 3.	<input type="text" value="001 Any Time"/>	<input checked="" type="checkbox"/> 4.	<input type="text" value="003 3"/>	<input type="checkbox"/> 5.	<input type="text" value="000 Deactivate"/>	<input type="checkbox"/> 6.	<input type="text" value="000 Deactivate"/>	<input checked="" type="checkbox"/> 7.	<input type="text" value="001 Any Time"/>	<input type="checkbox"/> 8.	<input type="text" value="000 Deactivate"/>
<b>Allowed Door :</b>	<b>Time Zone ID :</b>																		
<input checked="" type="checkbox"/> 1.	<input type="text" value="002 2"/>																		
<input checked="" type="checkbox"/> 2.	<input type="text" value="004 4"/>																		
<input checked="" type="checkbox"/> 3.	<input type="text" value="001 Any Time"/>																		
<input checked="" type="checkbox"/> 4.	<input type="text" value="003 3"/>																		
<input type="checkbox"/> 5.	<input type="text" value="000 Deactivate"/>																		
<input type="checkbox"/> 6.	<input type="text" value="000 Deactivate"/>																		
<input checked="" type="checkbox"/> 7.	<input type="text" value="001 Any Time"/>																		
<input type="checkbox"/> 8.	<input type="text" value="000 Deactivate"/>																		
<b>Group ID</b>	<p>Select your "Group ID" by serial number, default values : 000、001. The "Drop Down Menu" offers you all the serial number of Group ID as options, max. 255 groups allowed.</p>																		
▶ Button																			
<b>Delete</b>	Delete a Group ID.																		
<b>Set</b>	Enter the "Group Information" screen.																		

This is a screen to configure the door(s) of a Group ID, referring to the following picture:

### Group Information

---

<b>Allowed Door :</b> <input type="checkbox"/> 1.	<b>Time Zone ID :</b> 000 Deactivate ▼
--	---

---

<input type="button" value="Save"/>	<input type="button" value="Cancel"/>
-------------------------------------	---------------------------------------

### ◆ Illustration of Group Information

▶ Allowed Door	
<b>Door 1</b>	Tick the box of Door 1, then the user(s) assigned to the Group can be access Door 1 within the “Time Zone ID” indicated, otherwise prohibited.
<b>Tim Zone ID</b>	The “Drop Down Menu” displays all the “Time Zones” configured in the “Time Zone Setup” for option.
▶ Button	
<b>Save</b>	Save the “Group Information”.
<b>Cancel</b>	Cancel or Modify the “Group Information”

## ◆ Holiday Setup

Select "Holiday Setup" on the left side of the Main Window, you'll see the "Holiday setup" screen as below:

### Holiday setup

---

01 ▾ Month / 01 ▾ Date

---

Holiday List :

01 / 01	<input type="button" value="DELETE"/>	01 / 02	<input type="button" value="DELETE"/>	01 / 03	<input type="button" value="DELETE"/>
---------	---------------------------------------	---------	---------------------------------------	---------	---------------------------------------

---

## ◆ Illustration of Holiday Setup

▶ Holiday Setup	
<b>Month</b>	Select a month from the "Drop Down Menu".
<b>Date</b>	Select a date from the "Drop Down Menu".
▶ Button	
<b>Set</b>	Add a new Holiday.
<b>Delete</b>	Delete a Holiday.

## ◆ Door Setup

Select and Click”Door Setup” on the Main Window, you’ll see the “Door setting” screen as below:

### Door Setting

		<u>Door 1</u>
L10	First Admin Card IN TZ	000
L9	2/3 Badge+Admin P TZ	0(2)/0(2)
L8	2/3 Badge+Personal P TZ	0(2)/0(2)
L7	2/3 Badge TZ	0(2)/0(2)
L6	Card+Admin P TZ	0/0
L5	Admin P TZ	0/0
L4	Card+Personal P TZ	0/0
L3	P TZ	0/0
L2	Card Only TZ	0/0
L1	Card or P TZ	1/1
	Lock Release TZ	000
	Exit Button TZ	001
	APB IN/OUT	0/0
	Multiple Interlocking	N
	Remote Grant Needed	N
	Open Delay Time	10
	Door Open Delay Time	10
	Still Open Delay Time	0
	Degrade Mode	Deactivate
	Log Recorded/Sensor Mode	Y/None

## ◆ Illustration of Door Setting

► Door Setting	
<b>L10 : First Admin Card IN TZ</b>	Display the First Admin Card IN Time Zone from Door 1.
<b>L9: 2/3 Badge +Admin P TZ</b>	Display the Multiple Badge+ Admin Password Time Zone from Door 1, accompanied by a Double or Triple verifications.
<b>L8: 2/3 Badge +Personal P TZ</b>	Display the Multiple Badge +Personal Password Time Zone from Door 1, accompanied by a Double or Triple verifications.
<b>L7: 2/3 Badge TZ</b>	Display the Multiple Badge Time Zone from Door 1, accompanied by a Double or Triple verifications.
<b>L6: Card + Admin P TZ</b>	Display the Card +Admin Password Time Zone from Door 1.
<b>L5: Admin P TZ</b>	Display the Admin Password Time Zone from Door 1.
<b>L4: Card + Personal TZ</b>	Display the Card +Personal Password Time Zone from Door 1.
<b>L3: Common Password TZ</b>	Display the Common Password Time Zone from Door 1.
<b>L2: Card Only TZ</b>	Display the Card Only Time Zone from Door 1.
<b>L1: Card or Common Password TZ</b>	Display the Card or Common Password Time Zone from Door 1.
<b>Lock Release TZ</b>	Display the Lock Release Time Zone from Door 1.
<b>Exit Button TZ</b>	Display the Exit Button TZ from Door 1.
<b>APB IN/OUT</b>	Display the Anti Pass Back Level from Door 1, APB level : 0-255 for door IN/OUT.
<b>Multiple-Door Interlocking</b>	Display the Dual Interlocking function from Door 1, “Enabled” or “Disabled”.
<b>Remote Grant Needed</b>	Display the Remote Grant function from Door 1, “Enabled” or “Disabled”.
<b>Lock Release Time (Open Delay Time)</b>	Display the Door Lock Release Time from Door 1, 1 – 65535 seconds allowed and 10 seconds = default.
<b>Door Open Delay Time</b>	Display the Door Open Delay Time from Door 1, 10 seconds = default.
<b>Still Open Delay Time</b>	Set a time period (0~255 seconds) to adjust door sensor/relay reaction

<p><b>Degrade Mode</b></p>	<p>Set door access method with: Deactivated (Default)/Registered/FC/All  Deactivated =Default=Access Authority based on normal setup.  Registered: Users who have been registered to system can access the door  FC: Users may access door by punching card programmed with Facility Code and preset on SEMAC-D1 system. SEMAC-D1 system will verify only FC (Facility code).  All: User may access door by any kind of RFID cards</p> <p><b>Uni Setup</b></p> <hr/> <p>Wiegand Input :                      Format <input type="text" value="34 Bits"/> (Default: 34 Bits)  Connection with Software :        TCP Mode <input type="text" value="Realtime(Client)"/> (Default: Realtime Mode)  Access Log Password :                <input checked="" type="radio"/> ON <input type="radio"/> OFF  Facility Code(2 bytes in Decimal) : 1: <input type="text" value="0"/> 2: <input type="text" value="0"/> 3: <input type="text" value="0"/> 4: <input type="text" value="0"/> 5: <input type="text" value="0"/>  6: <input type="text" value="0"/> 7: <input type="text" value="0"/> 8: <input type="text" value="0"/> 9: <input type="text" value="0"/> 10: <input type="text" value="0"/>  DEC/HEX :                                <input checked="" type="radio"/> DEC <input type="radio"/> HEX  Card Format:                                <input checked="" type="radio"/> Raw Data <input type="radio"/> Facility Code+ID  LOGO_CONTROLLER :                    <input checked="" type="radio"/> Default <input type="radio"/> OFF</p> <p style="text-align: center;"><input type="button" value="SAVE"/></p>
<p><b>Log Recorded/Sensor Mode</b></p>	<p>Select the Access Log to be Recorded or Ignored and the Door Sensor Mode on Door 1.</p>
<p><b>Door 1 (on top)</b></p>	<p>Click “Door 1” to enter the “ Door 1 Setting” screen.</p>

## Door 1 Setting

First Admin Card IN Time Zone :	<input type="text" value="000 Deactivate"/>			
Multiple Badge+Admin Password Time Zone :	<input type="text" value="000 Deactivate"/>	<input type="text" value="Double"/>	<input type="text" value="000 Deactivate"/>	<input type="text" value="Double"/>
Multiple Badge+Personal Password Time Zone :	<input type="text" value="000 Deactivate"/>	<input type="text" value="Double"/>	<input type="text" value="000 Deactivate"/>	<input type="text" value="Double"/>
Multiple Badge Time Zone :	<input type="text" value="000 Deactivate"/>	<input type="text" value="Double"/>	<input type="text" value="000 Deactivate"/>	<input type="text" value="Double"/>
Card+Admin Password Time Zone :	<input type="text" value="000 Deactivate"/>		<input type="text" value="000 Deactivate"/>	
Admin Password Time Zone :	<input type="text" value="000 Deactivate"/>		<input type="text" value="000 Deactivate"/>	
Card+Personal Password Time Zone :	<input type="text" value="000 Deactivate"/>		<input type="text" value="000 Deactivate"/>	
Password Time Zone :	<input type="text" value="000 Deactivate"/>		<input type="text" value="000 Deactivate"/>	
Card Only Time Zone :	<input type="text" value="000 Deactivate"/>		<input type="text" value="000 Deactivate"/>	
Card or Password Time Zone :	<input type="text" value="001 Any Time"/>		<input type="text" value="001 Any Time"/>	
Lock Release Time Zone :	<input type="text" value="000 Deactivate"/>	First Card	<input type="text" value="No Need"/>	
Exit Button TZ :	<input type="text" value="001 Any Time"/>			
Anti Pass Back Level :	IN : <input type="text" value="0"/>	OUT : <input type="text" value="0"/>	( 0 - 255)	
Remote Grant Only:	<input type="text" value="Disabled"/>			
Lock Release Time :	<input type="text" value="10"/>	Sec ( 1 - 65535, 10 = default )		
Door Open Delay Time :	<input type="text" value="10"/>	Sec ( 1 - 65535, 10 = default )		
Access Log :	<input type="text" value="Recorded"/>			
Door Sensor Mode:	<input type="text" value="N/A"/>			
Still Open Delay Time :	<input type="text" value="0"/>	(1-255,0=default)		
Degrade Mode :	<input type="text" value="Deactivate"/>			

SEMI

## ◆ Illustrations of Door 1 Setting in Door Setup

▶ Door 1 Setting	
<p><b>First Admin Card IN Time Zone</b></p>	<p>Set up the time zone of First Administrator's Card to open the door as the bypass time zone of Door 1 ( default- "000 Deactivate"). When this time zone is chosen, the user can only use the card of Administrator to scan/sweep the controller first and the other users may enter Door 1. Nobody may enter without using this First Admin Card to scan the controller of Door 1 in advance.</p> <p>※ Should the user's bypass time zone level is L10, he/she may access by scanning the card and enter the Door 1 directly; however when the bypass time zone setup of Door 1 is " Lock Release Time Zone ", the user may access directly without any limitation.</p>
<p><b>Multiple Badge +Admin Password Time Zone</b></p>	<p>Set up the Multiple Badge + Administrator Password time zone as the bypass time zone of Door 1 ( default- "000 Deactivate"). <b>Before setting this time zone, you must choose the function of " Multi Badge Group "to come to the "Multi Badge Group " screen and give the user ID in this time zone, max. 3 user IDs allowed;</b> the user needs both 2 or 3 user ID cards and the Administrator's password to enter the Door 1 successfully. No any order limitation for scanning the cards first or enter the password first. You may scan the cards first then enter the password, or in reverse order.</p> <p>※ Should the user's bypass time zone level is L9~L10, he/she may access by scanning the card and enter the Door 1 directly; however when the bypass time zone setup of Door 1 is " Lock Release Time Zone ", the user may access directly without any limitation.</p>
<p><b>Multiple Badge +Personal Password Time Zone</b></p>	<p>Set up the Multiple Badge + Personal Password time zone as the bypass time zone of Door 1 ( default-000 Deactivate"). <b>Before setting this time zone, you must choose the function of "Multi Badge Group"to come to the "Multi Badge Group" screen and give the user ID in this time zone, max. 3 user IDs allowed;</b> the user needs both 2 or 3 user ID cards and the Personal password to enter the Door 1 successfully. No any order limitation for scanning the cards first or enter the password first. You may scan the cards first then enter the password, or in reverse order. However, the order of personal passwords will make differences. For example, there are two cards + passwords belonged to A and B. Should A card be scanned first, A has to enter his/her password first. Password B is not allowed to be entered before Password A.</p> <p>※ Should the user's bypass time zone level is L8~L10, he/she may access by scanning the card and enter the Door 1 directly; however when the bypass time zone setup of Door 1 is " Lock Release Time Zone ", the user may access directly without any limitation.</p>

<p><b>Multiple Badge Time Zone</b></p>	<p>Set up the Multiple Badge time zone as the bypass time zone of Door 1 ( default-“ 000 Deactivate“). <b>Before setting this time zone, you must choose the function of “Multi Badge Group”to come to the “Multi Badge Group” screen and give the user ID in this time zone, max. 3 user IDs allowed</b>; the user needs both 2 or 3 user ID cards to enter the Door 1 successfully. No any order limitation for scanning the cards          ※ Should the user’s bypass time zone level is L7~L10, he/she may access by scanning the card and enter the Door 1 directly; however when the bypass time zone setup of Door 1 is“ Lock Release Time Zone “, the user may access directly without any limitation.</p>
<p><b>Card +Admin Password Time Zone</b></p>	<p>Set up the Card + Admin Password time zone as the bypass time zone of Door 1 (default-“ 000 Deactivate“). The user has to scan the card and enter the Admin Password to access Door 1. No any order limitation for scanning the cards first or enter the password first.          ※ Should the user’s bypass time zone level is L6~L10, he/she may access by scanning the card and enter the Door 1 directly; however when the bypass time zone setup of Door 1 is“ Lock Release Time Zone “, the user may access directly without any limitation.</p>
<p><b>Admin Password Time Zone</b></p>	<p>Set up the Admin Password time zone as the bypass time zone of Door 1 (default-“000 Deactivate“). The user has to enter the Admin Password to access Door 1.          ※ Should the user’s bypass time zone level is L5~L10, he/she may access by scanning the card and enter Door 1 directly; however when the bypass time zone setup of Door 1 is“ Lock Release Time Zone “, the user may access directly without any limitation.</p>
<p><b>Card +Personal Password Time Zone</b></p>	<p>Set up the Card+ Personal Password time zone as the bypass time zone of Door 1 ( default-“ 000 Deactivate“). The user has to scan the card and enter the Personal Password to access Door 1. No any order limitation for scanning the cards first or enter the password first.          ※ Should the user’s bypass time zone level is L4~L10, he/she may access by scanning the card and enter Door 1 directly; however when the bypass time zone setup of Door 1 is“ Lock Release Time Zone “, the user may access directly without any limitation.</p>
<p><b>Password Time Zone</b></p>	<p>Set up the Common Password time zone as the bypass time zone of Door 1 (default-“000 Deactivate“). The user has to enter the Common Password to access Door 1.          ※ Should the user’s bypass time zone level is L3~L10, he/she may access by scanning the card and enter Door 1 directly; however when the bypass time zone setup of Door 1 is“ Lock Release Time Zone “, the user may access directly without any limitation.</p>

<b>Card Only Time Zone</b>	<p>Set up the Card Only time zone as the bypass time zone of Door 1 ( default –“ 000 Deactivate“). The user has to scan the card to access Door 1.</p> <p>※ Should the user’s bypass time zone level is L2~L10, he/she may access by scanning the card and enter Door 1 directly; however when the bypass time zone setup of Door 1 is“ Lock Release Time Zone “, the user may access directly without any limitation.</p>
<b>Card or Password Time Zone</b>	<p>Set up the Card or Common Password time zone as the bypass time zone of Door 1 ( default as “ 001 Any Time“). The user has to scan the card or enter the Common Password to access Door 1.</p> <p>※ Should the user’s bypass time zone level is L1~L10, he/she may access by scanning the card and enter Door 1 directly; however when the bypass time zone setup of Door 1 is“ Lock Release Time Zone “, the user may access directly without any limitation.</p>
<b>Lock Release Time Zone</b>	<p>Set up the Lock Release time zone as the bypass time zone of Door 1 (default–“000 Deactivate“). The user needs no any verification to access Door 1; however, if the“First Card”setup is “Needed”, the use has to scan a “First Card”in advance to activate the “Lock Release Time Zone” function.</p>
<b>Exit Button TZ</b>	<p>Set up the Exit Button time zone as the bypass time zone of Door 1, supporting “<b>OUT</b> ”for Door 1 only (default as “ 001 Any Time“).</p>
<b>Anti Pass Back Level</b>	<p>Set up the Anti Pass Back Level of “<b>IN</b>” and “<b>OUT</b>” for Door 1, level 0~255.</p>
<b>Dual Interlocking</b>	<p>Disable or Enable the “Dual Interlocking” function. Upon this function enabled, the user enters Door 1 and cannot enter the other door until Door 1 close.</p>
<b>Remote Grant</b>	<p>Disable or Enable the “Remote Grant” access control function. Upon this function enabled, the Software will take a remote control over the door’s open or close.</p>
<b>Lock Release Time</b>	<p>Set up the “Lock Release Time”, default as 10 seconds.</p>
<b>Door Open Delay Time</b>	<p>Set up “Door Open Delay Time” , default as 10 seconds.</p>
<b>Access Log / Door Sensor Mode</b>	<p>Set up “Ignored” or “Recorded”the Access Log (default as “Recorded”)</p> <p>Set up Door Sensor Mode, options for “Normal Open/Close” or “Circuit Short/Open” (default as “Normal Open/Close”). Should it is “Circuit Short/Open ” selected, the Door 1 Setting will display “Circuit Short” when the door is in short circuit or broken.</p>
<b>Still Open Delay Time</b>	<p>Set a time from 0~255 seconds for adjusting door sensor/relay reaction time difference</p>
<b>Degrade Mode</b>	<p>Select system verification mode: Deactivated/Registered/FC/ALL</p>

Remarks: Same setting for door 1

## ◆ Remote Control

Select and Click "Remote Control" on the left side of the Main Window, you'll see the "Door Status Monitoring /Security Bypass" screen as below:

### Door Status Monitoring

● No Response ● close ● open ● Circuit Short,Circuit Open,Intrude,Open too long

Door 1

Door State	●		
Fire Alarm Detection	off	Defense State	off

### Security Bypass

	Door 1
State	Normal

Door 1

SEMAAC

## ◆ Illustrations of Door Status Monitoring/Security Bypass

► Door Status Monitoring	
<b>Door Status</b>	<p>Display the most updated status from Door 1.</p> <p>No light Displayed indicated no response</p> <p>Green light indicated door closed</p> <p>Yellow light indicated door opened</p> <p>Red light indicated abnormal status (for example, short circuit, intruded, door opened too long, and so on)</p>
<b>Fire Alarm Detection</b>	Display whether the “ Fire Alarm Detection ”function enabled or not.
<b>Defense State</b>	Display whether the “ Defense State ”function enabled or not.
► Security Bypass	
<b>State</b>	Display the “Security Bypass State” from Door 1, Normal/Force Open/Force Close.
<b>Door 1</b>	Tick the box of Door 1 to monitor the Security Bypass of Door 1.
<b>Select All</b>	Click this button and tick all the boxes from Door 1.
<b>Cancel All</b>	Click this button and cancel all the ticks of the boxes before Door 1.
<b>Pulse Open Door</b>	Click this button to open the door(s) remotely for all the door(s) ticked. This function works when the Security Bypass state is normal.
<b>Force Close</b>	Click this button to make a force close on the door(s) remotely for all the door(s) ticked. Hence the state(s) of all the door(s) ticked will display “Force Close “. Even the RFID card scanned through the door(s), you may not access the door(s).
<b>Back to Normal</b>	Click this button to remotely restore all the door(s) ticked back to normal Security Bypass status.
<b>Force Open</b>	Click this button to make a force open on the door(s) remotely for all the door(s) ticked. Hence the state(s) of all the door(s) ticked will display “Force Open “ and the door(s) will stay at “Lock Release ” status.
<b>Emergency Open All Door</b>	Click this button to make a force open on all the door(s) remotely and the door(s) will stay at “Lock Release” status.
<b>Emergency Close All Door</b>	Click this button to make a force close on all the door(s) remotely and the door(s) cannot be accessed normally.
<b>Fire Alarm Detection ON</b>	Click this button to activate the “Fire Alarm Detection” function and the door(s) state will display “on”.
<b>Fire Alarm Detection OFF</b>	Click this button to deactivate the “Fire Alarm Detection” function and the door(s) state will display “off”.
<b>Alarm OFF</b>	Click this button to deactivate all the Alarms already triggered.

## ◆ Event Handle

Select "Event Handle" on the left side of the Main Window, you'll see the "Event Handle" screen as below:

### Event Handle

	<a href="#">Hard Alarm</a>	<a href="#">Soft Alarm1</a>	<a href="#">Soft Alarm2</a>	<a href="#">IP Camera</a>
Latched Time(Second)	0	0	0	0
<b>Event</b>				
Unregistered User	<input type="radio"/>	<input type="radio"/>	<input type="radio"/>	<input type="radio"/>
Deactivated User	<input type="radio"/>	<input type="radio"/>	<input type="radio"/>	<input type="radio"/>
Not Allowed Door	<input type="radio"/>	<input type="radio"/>	<input type="radio"/>	<input type="radio"/>
Time Zone Violation	<input type="radio"/>	<input type="radio"/>	<input type="radio"/>	<input type="radio"/>
Expired User	<input type="radio"/>	<input type="radio"/>	<input type="radio"/>	<input type="radio"/>
Anti Pass Back Violation	<input type="radio"/>	<input type="radio"/>	<input type="radio"/>	<input type="radio"/>
Door open too long	<input type="radio"/>	<input type="radio"/>	<input type="radio"/>	<input type="radio"/>
Door Intruded	<input type="radio"/>	<input type="radio"/>	<input type="radio"/>	<input type="radio"/>
Duress Alarm On	<input type="radio"/>	<input type="radio"/>	<input type="radio"/>	<input type="radio"/>
Fire Alarm On	<input type="radio"/>	<input type="radio"/>	<input type="radio"/>	<input type="radio"/>

SEMAAC

## ◆ Illustration of Event Handle

► Event Type	
<b>Latched Time</b>	<p>Set a latched time (0~65535 seconds) for Hard Alarm/Soft Alarm 1/Soft Alarm 2/IP Camera event trigger.</p> <p><b>Hard Alarm : Set Event to Trigger Hard Alarm</b></p> <p><b>Hard Alarm</b></p> <hr/> <p>Latched Time <input type="text" value="0"/> (sec,Max 65535 : 0 means unlimited)</p> <p> <input type="checkbox"/> Unregistered User    <input type="checkbox"/> Deactivated User    <input type="checkbox"/> Not Allowed Door    <input type="checkbox"/> Time Zone Violation    <input type="checkbox"/> Expired User  <input type="checkbox"/> Anti Pass Back Violation    <input type="checkbox"/> Door open too long    <input type="checkbox"/> Door Intruded    <input type="checkbox"/> Duress Alarm On    <input type="checkbox"/> Fire Alarm On </p> <p><input type="button" value="Set"/></p> <p><b>Soft Alarm 1 / Soft Alarm 2 :</b></p> <p><b>Soft Alarm1</b></p> <hr/> <p>Latched Time <input type="text" value="0"/> (sec,Max 65535 : 0 means unlimited)</p> <p> <input type="checkbox"/> Unregistered User    <input type="checkbox"/> Deactivated User    <input type="checkbox"/> Not Allowed Door    <input type="checkbox"/> Time Zone Violation    <input type="checkbox"/> Expired User  <input type="checkbox"/> Anti Pass Back Violation    <input type="checkbox"/> Door open too long    <input type="checkbox"/> Door Intruded    <input type="checkbox"/> Duress Alarm On    <input type="checkbox"/> Fire Alarm On </p> <p><input type="button" value="Set"/></p> <p><b>Soft Alarm2</b></p> <hr/> <p>Latched Time <input type="text" value="0"/> (sec,Max 65535 : 0 means unlimited)</p> <p> <input type="checkbox"/> Unregistered User    <input type="checkbox"/> Deactivated User    <input type="checkbox"/> Not Allowed Door    <input type="checkbox"/> Time Zone Violation    <input type="checkbox"/> Expired User  <input type="checkbox"/> Anti Pass Back Violation    <input type="checkbox"/> Door open too long    <input type="checkbox"/> Door Intruded    <input type="checkbox"/> Duress Alarm On    <input type="checkbox"/> Fire Alarm On </p> <p><input type="button" value="Set"/></p> <p><b>IP Camera : Even trigger type from IP Camera</b></p> <p><b>IP Camera</b></p> <hr/> <p> <input type="checkbox"/> Unregistered User    <input type="checkbox"/> Deactivated User    <input type="checkbox"/> Not Allowed Door    <input type="checkbox"/> Time Zone Violation    <input type="checkbox"/> Expired User  <input type="checkbox"/> Anti Pass Back Violation    <input type="checkbox"/> Door open too long    <input type="checkbox"/> Door Intruded    <input type="checkbox"/> Duress Alarm On    <input type="checkbox"/> Fire Alarm On </p> <p><input type="button" value="Set"/></p>
<b>Unregistered User</b>	<p>1、 It will be listed in the “Drop Down Menu”. When it’s selected and the user unregistered, one unregistered record will be shown on the “ Access Log ”screen (referring to the sample as below); if the event level equal to or higher than the “Alarm Trigger Level”, the Relay will be triggered and the E-mail will alert when “ E-mail Alerts ”is configured and one alert e-mail will be sent out.</p> <p>2、 When the “Latched Time : 0”, the alert can only be lifted/stopped by clicking “ Alarm OFF ”button on the “Door Status Monitoring/Security Bypass” screen of “Remote Control” function, default level = 0, referring to the below picture :</p>

<p><b>Deactivated User</b></p>	<p>1、It will be listed in the “Drop Down Menu”. When it’s selected and the user deactivated, one “Deactivated” message will be recorded and shown on the “Access Log”screen (referring to the example as below); if the event level equal to or higher than the “Alarm Trigger Level”, the Relay will be triggered and the E-mail will alert when “E-mail Alerts”is configured and one alert e-mail will be sent out.</p> <p>2、When the “Latched Time : 0”, the alert can only be lifted/stopped by clicking “ Alarm OFF ”button on the “Door Status Monitoring/Security Bypass” screen of “Remote Control” function, default level = 0.</p>
<p><b>Not Allowed Door</b></p>	<p>1、It will be listed in the “Drop Down Menu”. When it’s selected and the user’s “Group” setting different from the Door Settings, one “DISALLOWED DOOR” message will be recorded and shown on the “ Access Log ”screen; if the event level equal to or higher than the “Alarm Trigger Level”, the Relay will be triggered and the E-mail will alert when “ E-mail Alerts ”is configured and one alert e-mail will be sent out. (referring to below examples of user’s Group setting and Door setting) ( steps : Access Log→Click the User ID→Enter the “User RECORD” screen to modify the configuration of “Group”)</p> <p>2、When the “Latched Time : 0”, the alert can only be lifted/stopped by clicking “ Alarm OFF ”button on the “Door Status Monitoring/Security Bypass” screen of “Remote Control” function, default level = 0.</p>
<p><b>Multi-Badge Violation</b></p>	<p>1、It will be listed in the “Drop Down Menu”. When it’s selected and the “Multi-Badge “ verification failed, one “(1)DOUBLE REJ” message will be recorded and shown on the “ Access Log” screen (referring to the example as below); if the event level equal to or higher than the” Alarm Trigger Level”, the Relay will be triggered and the E-mail will alert when “ E-mail Alerts ”is configured and one alert e-mail will be sent out.</p> <p>2、When the “Latched Time : 0”, the alert can only be lifted/stopped by clicking “ Alarm OFF ”button on the “Door Status Monitoring/Security Bypass” screen of “Remote Control” function, default level = 0.</p>

<p><b>Time Zone Violation</b></p>	<p>1、It will be listed in the “Drop Down Menu”. When it’s selected and the user’s “Group” setting different from the Door Settings, one “(1)Open Time Error ”message will be recorded and shown on the Access Log ”screen (referring to the example as below); if the event level equal to or higher than the“ Alarm Trigger Level”, the Relay will be triggered and the E-mail will alert when “ E-mail Alerts ”is configured and one alert e-mail will be sent out.</p> <p>2、When the “Latched Time : 0”, the alert can only be lifted/stopped by clicking “ Alarm OFF ”button on the “Door Status Monitoring/Security Bypass” screen of “Remote Control” function, default level = 0.</p>
<p><b>Expired User</b></p>	<p>1、It will be listed in the “Drop Down Menu”. When it’s selected and the user’s “Expiry Date” overdue, one “(1)EXPIRED ”message will be recorded and shown on the Access Log ”screen (referring to the example as below); if the event level equal to or higher than the“ Alarm Trigger Level”, the Relay will be triggered and the E-mail will alert when “ E-mail Alerts ”is configured and one alert e-mail will be sent out.</p> <p>2、When the “Latched Time : 0”, the alert can only be lifted/stopped by clicking “ Alarm OFF ”button on the “Door Status Monitoring/Security Bypass” screen of “Remote Control” function, default level = 0.</p>
<p><b>Anti Pass Back Violation</b></p>	<p>1、It will be listed in the “Drop Down Menu”. When it’s selected and the doors with “Anti Pass Back Level ”configuration, one “(1)ANTI_PB REJ ”message will be recorded and shown on the Access Log ”screen (referring to the example as below); if the event level equal to or higher than the“ Alarm Trigger Level”, the Relay will be triggered and the E-mail will alert when “ E-mail Alerts ”is configured and one alert e-mail will be sent out.</p> <p>2、When the “Latched Time : 0”, the alert can only be lifted/stopped by clicking “ Alarm OFF ”button on the “Door Status Monitoring/Security Bypass” screen of “Remote Control” function, default level = 0.</p> <p>※ Only 1 Door (2 way ) is supported with this function.</p>

<p><b>Door open too long</b></p>	<p>1、It will be listed in the “Drop Down Menu”. When it’s selected and the door closes over the time set after the user card being scanned, one “(O)Open too long ”message will be recorded and shown on the Access Log ”screen (referring to the example as below); if the event level equal to or higher than the“ Alarm Trigger Level”, the Relay will be triggered and the E-mail will alert when “ E-mail Alerts ”is configured and one alert e-mail will be sent out.</p> <p>2、When the “Latched Time : 0”, the alert can only be lifted/stopped by clicking “ Alarm OFF ”button on the “Door Status Monitoring/Security Bypass” screen of “Remote Control” function, default level = 0.</p>
<p><b>Door Intruded</b></p>	<p>1、It will be listed in the “Drop Down Menu”. When it’s selected and the door is accessed forcibly and abnormally, one “(O) DOOR INTRUDED ” message will be shown on the Access Log ”screen (referring to the example as below); if the event level equal to or higher than the “ Alarm Trigger Level”, the Relay will be triggered and the E-mail will alert when “ E-mail Alerts ”is configured and one alert e-mail will be sent out.</p> <p>2、When the “Latched Time : 0”, the alert can only be lifted/stopped by clicking “ Alarm OFF ”button on the “Door Status Monitoring/Security Bypass” screen of “Remote Control” function, default level = 4.</p>
<p><b>Duress Alarm On</b></p>	<p>1、It will be listed in the “Drop Down Menu”. When it’s selected and the “Duress Alarm ”of a door is triggered by the user ( note : you have to key in the “Anti Duress Password” and press “ENT ”before scanning the user card), one “ANTI DURESS” message will be shown on the Access Log ”screen; if the event level equal to or higher than the “ Alarm Trigger Level”, the Relay will be triggered and the E-mail will alert when “ E-mail Alerts ”is configured and one alert e-mail will be sent out.</p> <p>2、When the “Latched Time : 0”, the alert can only be lifted/stopped by clicking “ Alarm OFF ”button on the “Door Status Monitoring/Security Bypass” screen of “Remote Control” function, default level = 4.</p>
<p><b>Fire Alarm On</b></p>	<p>1、It will be listed in the “Drop Down Menu”. When it’s selected and if the “Fire Alarm ”is triggered, one “FIRE ALARM” message will be recorded and shown on the Access Log ”screen; if the event level equal to or higher than the “ Alarm Trigger Level”, the Relay will be triggered and the E-mail will alert when “ E-mail Alerts ”is configured and one alert e-mail will be sent out.</p> <p>2、When the “Latched Time : 0”, the alert can only be lifted/stopped by clicking “ Alarm OFF ”button on the “Door Status Monitoring/Security Bypass” screen of “Remote Control” function, default level = 5.</p>

## ◆ Multi Badge Group

Select and Click "Multi Badge Group" on the left side of the Main Window, you'll see the "Multi Badge Group" screen as below:

### Multi Badge Group

Multi Badge Group	User ID 1	User ID 2	User ID 3
1.	<input type="text"/>	<input type="text"/>	<input type="text"/>
2.	<input type="text"/>	<input type="text"/>	<input type="text"/>
3.	<input type="text"/>	<input type="text"/>	<input type="text"/>
4.	<input type="text"/>	<input type="text"/>	<input type="text"/>
5.	<input type="text"/>	<input type="text"/>	<input type="text"/>
6.	<input type="text"/>	<input type="text"/>	<input type="text"/>
7.	<input type="text"/>	<input type="text"/>	<input type="text"/>
8.	<input type="text"/>	<input type="text"/>	<input type="text"/>
9.	<input type="text"/>	<input type="text"/>	<input type="text"/>
10.	<input type="text"/>	<input type="text"/>	<input type="text"/>
<input type="button" value="set"/>			

## ◆ Illustration of Multi Badge Group

► Multi Badge Group	
<b>Multi Badge Group</b>	Max. 10 Groups to be set.
<b>User ID 1</b>	Enter the User ID 1 for Multi Badge Group.
<b>User ID 2</b>	Enter the User ID 2 for Multi Badge Group.
<b>User ID 3</b>	Enter the User ID 3 for Multi Badge Group.
<b>Set ( button)</b>	Save all the configurations.

## ➤ TOOLS

### ◆ IP Camera

Select "IP Camera" on the left side of the Main Window, you'll see the "IP Camera" screen as the following example:



### ◆ Illustration of IP Camera

▶ IP Camera	
<b>IP Camera 1</b>	Enter the IP address of IP Camera 1 to be lined.
<b>Door 1</b>	Display the captured and the most updated picture of Door 1.
<b>SET ( button)</b>	Save all the configurations.
<b>Refresh ( button)</b>	Refresh the WEB page of IP Camera.

### ◆ Backup

SEMAC-D system can be backup for restore to system again by selecting: Database/User Data/User list, as below:

#### Backup

---

**Tips :**

**This command will export the User Registry data for backup purpose.**

Database(database.cfg)  User Data(userdata.cfg)  User List(userlist.txt)

BACKUP

## ◆ Restore

SEMAC-D system can be backup and restore to SEMAC-D again. Only Database/User List available.

### RESTORE / IMPORT

Select a File to Restore / Import :

 瀏覽...

Database(database.cfg/userdata.cfg)  User List(userlist.txt)

(It may takes few minutes to restore the database.)

Restore

## ◆ Reboot

Select "Reboot" on the left side of the Main Window, you'll see the "Reboot System" screen as below:

### Reboot System

REBOOT

## ◆ Illustration of Reboot

### ► Button

Reboot	Reboot the SEMAC-D1, similar to warm boot a computer.
--------	---

## ◆ Upgrade Firmware

Select "Upgrade FIRMWARE" on the left side of the Main Window, you'll see the "FIRMWARE UPGRADE" screen as below:

### FIRMWARE UPGRADE

Warning: Upgrade must NOT be interrupted

Please select a file to upgrade :  瀏覽...

UPGRADE



## ◆ Illustration of Upgrade Firmware

### ► Steps

Press button "Browse" to search your firmware to be upgraded.  
Press button "Upgrade" to execute the firmware upgrade action.

### ► Note

Please upgrade the "System Code" first then upgrade "WEB code".

## ◆ Reset

Select "Reset" on the left side of the Main Window, you'll see the "Reset" screen as below:

### Reset

User Data  Access Logs  Group  Time Zone  Time Set  Holiday  System Logs

SELECT ALL

DELETE

Reset System to Factory Default - Factory Default

## ◆ Illustration of Reset

▶ Data Reset	
<b>User Data</b>	Tick the box before "User Data" and Click "DELETE" button to delete all the User Data.
<b>Access Log</b>	Tick the box before "Access Log" and Click "DELETE" button to delete all the Access Logs.
<b>Group</b>	Tick the box before "Group" and Click "DELETE" button to delete all the Groups.
<b>Time Zone</b>	Tick the box before "Time Zone" and Click "DELETE" button to delete all the Time Zone configurations.
<b>Time Set</b>	Tick the box before "Time Set" and Click "DELETE" button to delete all the Time Set configurations.
<b>Holiday</b>	Tick the box before "Holiday" and Click "DELETE" button to delete all the Holiday configurations.
<b>System Logs</b>	Tick the box before "System Logs" and Click "DELETE" button to delete all the System Logs.
▶ Button	
<b>Select All</b>	Tick the box before above item.
<b>Delete</b>	Delete above item(s) selected.
<b>Steps :</b>	
1、Tick the item above to be deleted.	
2、Click button "Delete".	
▶ Reset System to Factory Default	
<b>Factory Default</b>	Execute this command to restore the system back to the factory default.